

330, 331 & 332 Roll Up and Media Assembly Instructions

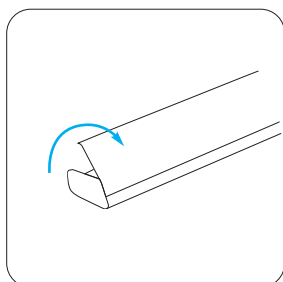

1. Remove contents from bag and inner packaging. Open snap rail using 2 hands.

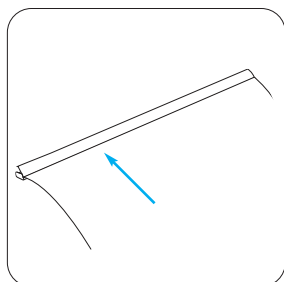

2. Slide media into the bottom end of the snap rail.

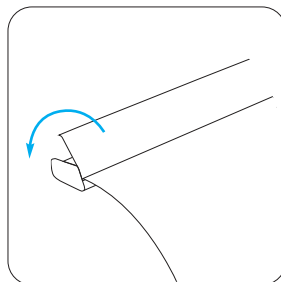

3. Push the snap rail closed ensuring the media is secure.

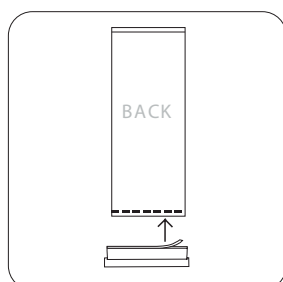

4. Pull back self-adhesive strip located on the media attached to the cassette. Slowly apply the tape to the back of your media ensuring its straight and secure.

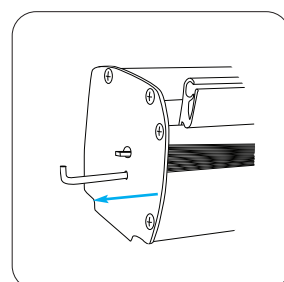

5. Hold the snap rail and the cassette securely and remove the pin from the side of the cassette to engage the mechanism.

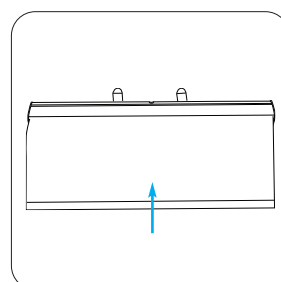

6. Slowly feed the media into the cassette keeping it as straight as possible whilst allowing the mechanism to wind.

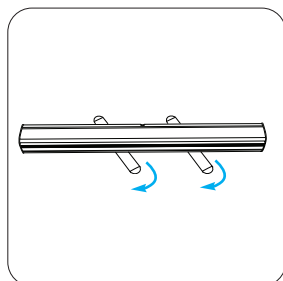

7. Turn both feet clockwise until they are right angles to the main cassette.

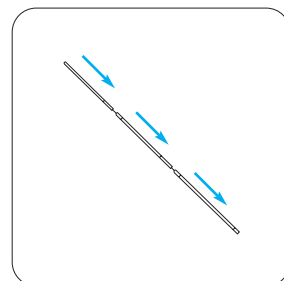

8. Remove the telescopic pole and fully extend. Push each section into the next to lock into place.

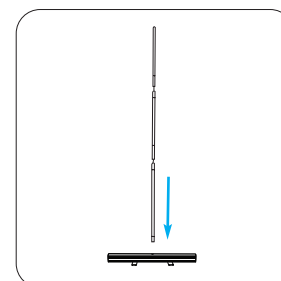

9. Insert the pole into the hole in the top of the cassette.

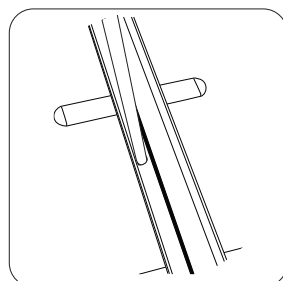

10. Ensure the pole is located onto the plastic lug securely. The lug sits inside the channel below the pole insert hole.

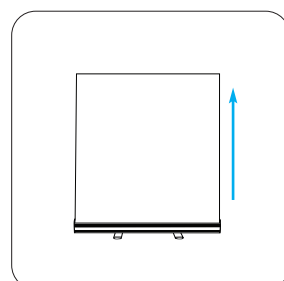

11. Whilst holding the cassette and snap rail begin slowly pulling the media out from the cassette until unwound.

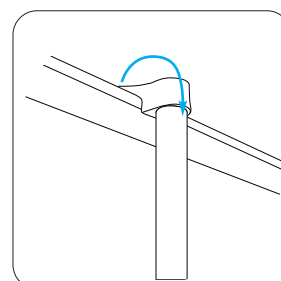

9. Locate the back channel of the snap rail onto the plastic adaptor at the top of the pole. Repeat steps in reverse to disassemble.

